

PART NUMBER	WEATHERHEAD CATALOG NUMBER	TH'D "P1"	TH'D "P2"	A REF	B REF (INCH)
259-2096-2	3321X2	1/8-27	1/8-27	19 [.75]	5/8
259-2096-4	3321X4	1/4-18	1/4-18	28.7 [1.13]	3/4
259-2096-4-2	3321X4X2	1/4-18	1/8-27	28.7 [1.13]	3/4
259-2096-6	3321X6	3/8-18	3/8-18	28.7 [1.13]	7/8
259-2096-6-4	3321X6X4	3/8-18	1/4-18	28.7 [1.13]	7/8
259-2096-8	3321X8	1/2-14	1/2-14	38.1 [1.50]	1 1/8
259-2096-8-4	3321X8X4	1/2-14	1/4-18	38.1 [1.50]	1 1/8
259-2096-8-6	3321X8X6	1/2-14	3/8-18	38.1 [1.50]	1 1/8
259-2096-12	3321X12	3/4-14	3/4-14	38.9 [1.53]	1 3/8
259-2096-16	3321X16	1-11 1/2	1-11 1/2	48 [1.89]	1 5/8
259-2096-20	3321X20	1 1/4-11 1/2	1 1/4-11 1/2	49 [1.93]	2
259-2096-24	3321X24	1 1/2-11 1/2	1 1/2-11 1/2	49 [1.93]	2 3/8

REVISIONS			
REV	DESCRIPTION	DATE	APPROVED
E	REDRAWN & REACTIVATED - LAST REV "D" 1) ADDED PARTS # 259-2096-4, 259-2096-4-2, 259-2096-8, 259-2096-8-4, 259-2096-8-6 & 259-2096-12,	2010-11-15 SJM/YPK	0046930 -ECO DP-1299
F	1) ADDED PART # 259-2096-6-4	2012-04-04 MBK/PSW	0068306 -ECO
G	1) ADDED PART # 259-2096-16 AND 259-2096-24 2) DIMENSION WAS 24.4 [.96] 3) DIMENSION WAS 32.5 [1.28] 4) DIMENSION WAS 35.1 [1.38]	2013-10-30 MBK/DHS	0090663 -ECO

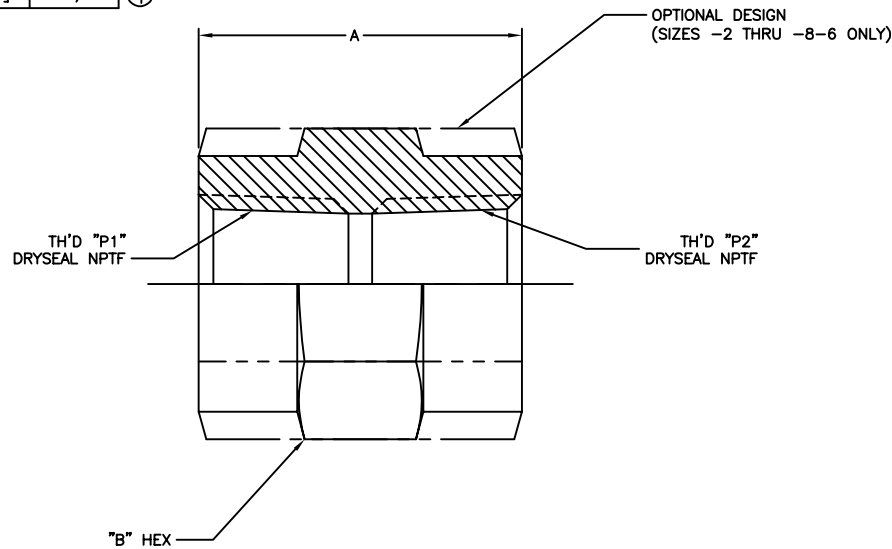

2. MATERIAL: AISI 316 STAINLESS STEEL.  
1. DIMENSIONS ARE IN MILLIMETERS [INCHES].

DRAWN S. MANE	<b>EATON</b>	INDUSTRIAL SECTOR HYDRAULICS GROUP, FLUID CONVEYANCE PRODUCTS, MAUMEE, OHIO U.S.A.	
CHECKED Y. KULKARNI		DRAWING TITLE <b>ADAPTER HEXAGON PIPE COUPLING (SAE #140138)</b>	
APPROVED J. SNYDER	SIZE A2	DRAWING NUMBER 259-2096	REV G
RELEASE DATE 2010-11-15 0046930-ECO DP-1299	SCALE NONE	DIST U	CAGE CODE 01276
THIRD ANGLE PROJECTION	SHEET 1	CONFIDENTIAL AND PROPRIETARY NOTICE TO PERSONS RECEIVING THIS DRAWING AND/OR TECHNICAL INFORMATION THIS DRAWING IS THE PROPERTY OF EATON. IT IS TO BE USED ONLY FOR THE PURPOSES AND IN THE MANNER SPECIFIED BY THE DRAWING. IT IS NOT TO BE REPRODUCED, COPIED, OR TRANSMITTED IN ANY FORM OR BY ANY MEANS, ELECTRONIC OR MECHANICAL, INCLUDING PHOTOCOPYING, RECORDING, OR BY ANY INFORMATION STORAGE AND RETRIEVAL SYSTEM, WITHOUT THE WRITTEN PERMISSION OF EATON. THE USER SHALL OBTAIN THE RESULTS OF THIS DOCUMENT. EATON CORPORATION - 17000 E. EATON BLVD. - IRVING, TX 75039	

DWG. NO. 259-2096  
SHEET 1 OF 1  
REV. G