

AEROQUIP PART NUMBER	WEATHERHEAD PART NUMBER	TH'D "P ₁ "	TH'D "P ₂ "	A REF	B REF	C REF	D REF
2081-4-2S	C3109X4X2	1/4-18	1/8-27	21.6 [.85]	14.7 [.58]	7.1 [.28]	5/8
2081-6-2S	C3109X6X2	3/8-18	1/8-27	21.6 [.85]	14.7 [.58]	7.6 [.30]	3/4
2081-6-4S	C3109X6X4	3/8-18	1/4-18	25.4 [1.00]	14.7 [.58]	10.4 [.41]	3/4
2081-8-2S	C3109X8X2	1/2-14	1/8-27	27.9 [1.10]	19.3 [.76]	7.6 [.30]	7/8
2081-8-4S	C3109X8X4	1/2-14	1/4-18	27.9 [1.10]	19.3 [.76]	9.9 [.39]	7/8
2081-8-6S	C3109X8X6	1/2-14	3/8-18	28.4 [1.12]	19.3 [.76]	13.5 [.53]	7/8
2081-12-4S	C3109X12X4	3/4-14	1/4-18	29.7 [1.17]	19.3 [.76]	9.9 [.39]	1 1/8
2081-12-6S	C3109X12X6	3/4-14	3/8-18	29.7 [1.17]	19.3 [.76]	13.5 [.53]	1 1/8
2081-12-8S	C3109X12X8	3/4-14	1/2-14	34.5 [1.36]	19.3 [.76]	16.8 [.66]	1 1/8
2081-16-6S	C3109X16X6	1-11 1/2	3/8-18	34.5 [1.36]	24.4 [.96]	14 [.55]	1 3/8
2081-16-4S	C3109X16X4	1-11 1/2	1/4-18	34.5 [1.36]	24.4 [.96]	9.9 [.39]	1 3/8
2081-16-8S	C3109X16X8	1-11 1/2	1/2-14	34.5 [1.36]	24.4 [.96]	17 [.67]	1 3/8
2081-16-12S	C3109X16X12	1-11 1/2	3/4-14	37.8 [1.49]	24.4 [.96]	22.4 [.88]	1 3/8
2081-20-8S	C3109X20X8	1 1/4-11 1/2	1/2-14	37.3 [1.47]	24.9 [.98]	17 [.67]	1 3/4
2081-20-12S	C3109X20X12	1 1/4-11 1/2	3/4-14	37.3 [1.47]	24.9 [.98]	21.8 [.86]	1 3/4
2081-20-16S	C3109X20X16	1 1/4-11 1/2	1-11 1/2	40.9 [1.61]	24.9 [.98]	26.9 [1.06]	1 3/4
2081-24-12S	C3109X24X12	1 1/2-11 1/2	3/4-14	39.9 [1.57]	25.9 [1.02]	21.8 [.86]	2
2081-24-16S	C3109X24X16	1 1/2-11 1/2	1-11 1/2	39.9 [1.57]	25.9 [1.02]	26.9 [1.06]	2
2081-24-20S	C3109X24X20	1 1/2-11 1/2	1 1/4-11 1/2	39.9 [1.57]	25.9 [1.02]	36.6 [1.44]	2
2081-32-16S	C3109X32X16	2-11 1/2	1-11 1/2	44.4 [1.75]	26.4 [1.04]	26.9 [1.06]	2 1/2
2081-32-20S	C3109X32X20	2-11 1/2	1 1/4-11 1/2	44.4 [1.75]	26.4 [1.04]	36.6 [1.44]	2 1/2
2081-32-24S	C3109X32X24	2-11 1/2	1 1/2-11 1/2	44.4 [1.75]	26.4 [1.04]	42.9 [1.69]	2 1/2

REVISIONS			
REV	DESCRIPTION	DATE	APPROVED
S	REDRAWN, UPDATED TO LATEST EATON FORMAT & DIMENSION STYLE. 1) "A" DIM. FOR 2081-24-20S WAS 43.4 [1.71] REF.	2011-07-05 DHS	0057296-ECO DP-1299
T	1) ADDED PARTS 2081-16-4S & 2081-20-8S	2012-04-12 ADM/VJS	0068801-ECO

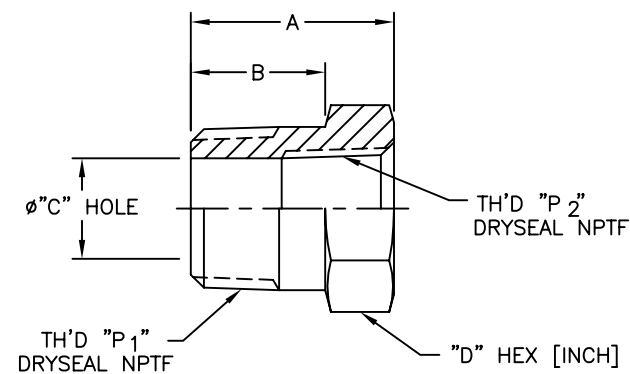

2. MATERIAL: STEEL.

1. DIMENSIONS ARE IN MILLIMETERS [INCHES].

METRIC

DRAWN D. SHEWALE CHECKED D. SHEWALE APPROVED J. LUGNBILL RELEASE DATE 2011-07-05 0057296-ECO DP-1299 THIRD ANGLE PROJECTION		INDUSTRIAL SECTOR HYDRAULICS GROUP, FLUID CONVEYANCE PRODUCTS, MAUMEE, OHIO U.S.A.
DRAWING TITLE		
ADAPTER REDUCER BUSHING (SAE #140140)		
SIZE A2	DRAWING NUMBER 2081-S	REV T
SCALE NONE	DIST U	CAGE CODE 01276
SHEET		1
<small>CONFIDENTIAL AND PROPRIETARY NOTICE TO PERSONS RECEIVING THIS DRAWING AND/OR TECHNICAL INFORMATION: THIS DOCUMENT, INCLUDING THE DRAWING AND INFORMATION CONTAINED THEREON, IS CONFIDENTIAL AND IS THE EXCLUSIVE PROPERTY OF EATON CORPORATION. MERELY ON LOAN AND SUBJECT TO RECALL BY EATON AT ANY TIME. BY PRINTING, PHOTOCOPYING, OR OTHERWISE REPRODUCING OR DISSEMINATING THIS DOCUMENT WITHOUT THE WRITTEN CONSENT OF EATON, THE USER SHALL BE CONSIDERED TO HAVE ACCEPTED THE STATUS OF THIS DOCUMENT. © 2008 Eaton Corporation - All Rights Reserved.</small>		

DWG. NO. 2081-S
 SH. 1
 REV. T