

PART NUMBER	WHEATHERHEAD PART NUMBER	TH'D T ₁	TH'D T ₂	A REF	B REF	C REF	D REF	E REF	F REF
202702-2-2S	C5315X2	5/16-24	5/16-24	26.9 [1.06]	7.6 [30]	11.4 [45]	1.5 [06]	1.5 [06]	11.2 [44]
202702-3-3S	C5315X3	3/8-24	3/8-24	27.9 [1.10]	7.6 [30]	12.2 [48]	3.0 [12]	3.0 [12]	12.7 [50]
202702-3-6S	C5315X6X3	3/8-24	9/16-18	33 [1.30]	7.6 [30]	14.2 [56]	3.0 [12]	7.6 [30]	15.7 [62]
202702-4-3S	C5315X3X4	7/16-20	3/8-24	29.4 [1.16]	9.1 [36]	12.2 [48]	4.3 [17]	3.3 [13]	14.2 [56]
202702-4-4S	C5315X4	7/16-20	7/16-20	31.2 [1.23]	9.1 [36]	14.0 [55]	4.3 [17]	4.3 [17]	14.2 [56]
202702-4-5S	C5315X5X4	7/16-20	1/2-20	31.2 [1.23]	9.1 [36]	14.0 [55]	4.3 [17]	5.8 [23]	15.7 [62]
202702-4-6S	C5315X6X4	7/16-20	9/16-18	32.3 [1.27]	9.1 [36]	14.2 [56]	4.3 [17]	7.6 [30]	15.7 [62]
202702-4-8S	C5315X8X4	7/16-20	3/4-16	37.8 [1.49]	9.1 [36]	16.8 [66]	4.3 [17]	9.9 [39]	20.6 [81]
202702-5-4S	C5315X4X5	1/2-20	7/16-20	31.2 [1.23]	9.1 [36]	14.0 [55]	5.8 [23]	4.3 [17]	15.7 [62]
202702-5-5S	C5315X5	1/2-20	1/2-20	31.2 [1.23]	9.1 [36]	14.0 [55]	5.8 [23]	5.8 [23]	15.7 [62]
202702-5-6S	C5315X6X5	1/2-20	9/16-18	32.3 [1.27]	9.1 [36]	14.2 [56]	5.8 [23]	7.6 [30]	15.7 [62]
202702-6-4S	C5315X4X6	9/16-18	7/16-20	32.8 [1.29]	9.9 [39]	14.0 [55]	7.6 [30]	4.3 [17]	17.5 [69]
202702-6-5S	C5315X5X6	9/16-18	1/2-20	32.8 [1.29]	9.9 [39]	14.0 [55]	7.6 [30]	5.8 [23]	17.5 [69]
202702-6-6S	C5315X6	9/16-18	9/16-18	33.0 [1.30]	9.9 [39]	14.2 [56]	7.6 [30]	7.6 [30]	17.5 [69]
202702-6-8S	C5315X8X6	9/16-18	3/4-16	36.6 [1.44]	9.9 [39]	16.8 [66]	7.6 [30]	9.9 [39]	20.6 [81]
202702-6-10S	C5315X10X6	9/16-18	7/8-14	43.4 [1.71]	9.9 [39]	19.3 [76]	7.6 [30]	12.2 [48]	23.9 [94]
202702-8-4S	C5315X4X8	3/4-16	7/16-20	34.8 [1.37]	11.1 [44]	14.0 [55]	9.9 [39]	4.3 [17]	22.3 [88]
202702-8-5S	C5315X5X8	3/4-16	1/2-20	34.8 [1.37]	11.1 [44]	14.0 [55]	9.9 [39]	5.8 [23]	22.3 [88]
202702-8-6S	C5315X6X8	3/4-16	9/16-18	35.0 [1.38]	11.1 [44]	14.2 [56]	9.9 [39]	7.6 [30]	22.3 [88]
202702-8-8S	C5315X8	3/4-16	3/4-16	37.6 [1.48]	11.1 [44]	16.8 [66]	9.9 [39]	9.9 [39]	22.3 [88]
202702-8-10S	C5315X10X8	3/4-16	7/8-14	41.7 [1.64]	11.1 [44]	19.3 [76]	9.9 [39]	12.2 [48]	23.9 [94]
202702-8-12S	C5315X12X8	3/4-16	1 1/16-12	49.3 [1.94]	11.1 [44]	21.8 [86]	9.9 [39]	15.5 [61]	28.4 [112]
202702-8-16S	C5315X16X8	3/4-16	1 5/16-12	47.2 [1.86]	11.1 [44]	23.1 [91]	9.9 [39]	21.3 [84]	35.0 [138]
202702-10-4S	C5315X4X10	7/8-14	7/16-20	37.8 [1.49]	12.7 [50]	14.0 [55]	12.2 [48]	4.3 [17]	25.4 [100]
202702-10-6S	C5315X6X10	7/8-14	9/16-18	38.1 [1.50]	12.7 [50]	14.2 [56]	12.2 [48]	7.6 [30]	25.4 [100]
202702-10-8S	C5315X8X10	7/8-14	3/4-16	40.6 [1.60]	12.7 [50]	16.8 [66]	12.2 [48]	9.9 [39]	25.4 [100]
202702-10-10S	C5315X10	7/8-14	7/8-14	43.2 [1.70]	12.7 [50]	19.3 [76]	12.2 [48]	12.2 [48]	25.4 [100]
202702-10-12S	C5315X12X10	7/8-14	1 1/16-12	47.7 [1.88]	12.7 [50]	21.8 [86]	12.2 [48]	15.5 [61]	28.4 [112]
202702-10-16S	C5315X16X10	7/8-14	1 5/16-12	52.6 [2.07]	12.7 [50]	23.1 [91]	12.2 [48]	21.3 [84]	35.0 [138]
202702-12-4S	C5315X4X12	1 1/16-12	7/16-20	42.0 [1.65]	15.0 [59]	14.0 [55]	15.5 [61]	4.3 [17]	31.7 [125]
202702-12-6S	C5315X6X12	1 1/16-12	9/16-18	42.2 [1.66]	15.0 [59]	14.2 [56]	15.5 [61]	7.6 [30]	31.7 [125]
202702-12-8S	C5315X8X12	1 1/16-12	3/4-16	44.7 [1.76]	15.0 [59]	16.8 [66]	15.5 [61]	9.9 [39]	31.7 [125]

REVISIONS			
REV	DESCRIPTION	DATE	APPROVED
AL 1.)	ADD CATALOG NUMBER	2003-10-16 JEEJ	EN-F25097 DP-1511
AM 1.)	DRAWING NUMBER WAS "20702" IN ERROR	2003-12-05 BAT/WRH	EN-F25539 DP-24901
AN 1.)	ADDED PART #202702-4-3S, #202702-8-16S & #202702-12-4S.	2011-08-07 NUD/AGV	0054026-ECO
AP 1.)	ADDED PART #202702-2-2S, #202702-3-3S, #202702-4-5S & #202702-6-5S. 2) WAS #C53X6X5.	2012-01-11 ONU/VJS	0065022-ECO DP-1299

METRIC

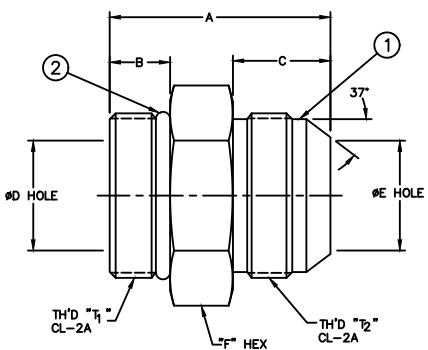

1. DIMENSIONS ARE IN MILLIMETERS [INCHES].

202702-8-16S	C5315X16X8	202701-8-16S	22617-8
202702-4-3S	C5315X3X4	202701-4-3S	22617-4
202702-12-4S	C5315X4X12	202701-12-4S	22617-12
202702-12-8S	C5315X8X12	202701-12-8S	22617-12
202702-12-6S	C5315X6X12	202701-12-6S	22617-12
202702-10-16S	C5315X16X10	202701-10-16S	22617-10
202702-10-12S	C5315X12X10	202701-10-12S	22617-10
202702-10-10S	C5315X10	202701-10-10S	22617-10
202702-10-8S	C5315X8X10	202701-10-8S	22617-10
202702-10-6S	C5315X6X10	202701-10-6S	22617-10
202702-10-4S	C5315X4X10	202701-10-4S	22617-10
202702-8-12S	C5315X12X8	202701-8-12S	22617-8
202702-8-10S	C5315X10X8	202701-8-10S	22617-8
202702-8-8S	C5315X8	202701-8-8S	22617-8
202702-8-6S	C5315X6X8	202701-8-6S	22617-8
202702-8-5S	C5315X5X8	202701-8-5S	22617-8
202702-8-4S	C5315X4X8	202701-8-4S	22617-8
202702-6-10S	C5315X10X6	202701-6-10S	22617-6
202702-6-8S	C5315X8X6	202701-6-8S	22617-6
202702-6-6S	C5315X6	202701-6-6S	22617-6
202702-6-5S	C5315X5X6	202701-6-5S	22617-6
202702-6-4S	C5315X4X6	202701-6-4S	22617-6
202702-5-6S	C5315X6X5	202701-5-6S	22617-5
202702-5-5S	C5315X5	202701-5-5S	22617-5
202702-5-4S	C5315X4X5	202701-5-4S	22617-5
202702-4-8S	C5315X8X4	202701-4-8S	22617-4
202702-4-6S	C5315X6X4	202701-4-6S	22617-4
202702-4-5S	C5315X5X4	202701-4-5S	22617-4
202702-4-4S	C5315X4	202701-4-4S	22617-4
202702-3-6S	C5315X6X3	202701-3-6S	22617-3
202702-3-3S	C5315X3	202701-3-3S	22617-3
202702-2-2S	C5315X2	202701-2-2S	22617-2
PART NUMBER	WEATHERHEAD PART NUMBER	① ADAPTER	② O'RING

LIST OF MATERIALS

ITEM NO.	MATERIAL
1	STEEL
2	NITRILE(BUNA-N)

DRAWN: J. EBERSOLE
 CHECKED: B. THOMAS
 APPROVED: B. THOMAS
 RELEASE DATE: 2003-10-16
 EN-F25097
 DP-1511
 THIRD ANGLE PROJECTION

FLUID CONVEYANCE DIVISION
 DRAWING TITLE: ADAPTER
 SAE 37° FLARE-STRAIGHT THREAD CONNECTOR SHORT (SAE #070120)
 SIZE: A2
 DRAWING NUMBER: 202702
 PAGE CODE: 01276
 SHEET: 1

THE REPRODUCTION, DISTRIBUTION AND UTILIZATION OF THIS DOCUMENT AS WELL AS THE COMMUNICATION OF ITS CONTENTS TO OTHERS WITHOUT EXPLICIT AUTHORIZATION IS PROHIBITED. OFFENDERS WILL BE HELD LIABLE FOR THE PAYMENT OF DAMAGES. ALL RIGHTS RESERVED IN THE EVENT OF THE GRANT OF A PATENT, UTILITY MODEL OR DESIGN. (PER ISO 10166)