

REVISIONS			
REV	DESCRIPTION	DATE	APPROVED
G	REDRAWN - SUPERSEDES 1SA_FRB-SHEET 3 REV."F" FOR 1SA8FRB6	11-3-95	EN-F16053 DP-24900
H	1) FINISH WAS ZINC PLATE PER ACES 2751*.	2020-07-20 ASB	CO-0206072

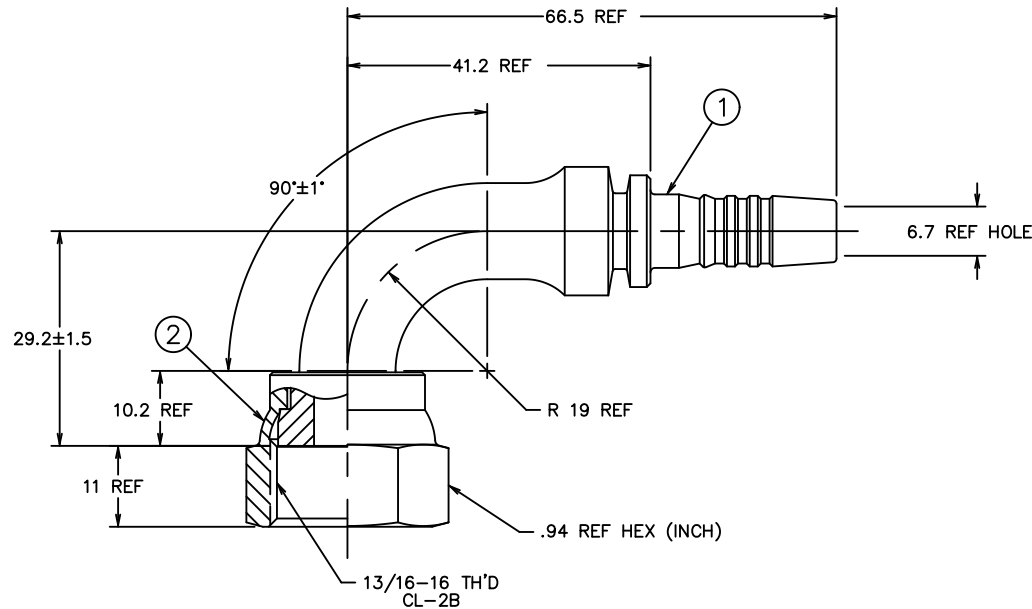

66.5	2.62
41.2	1.62
29.2±1.5	1.15±.06
19	.75
11	.43
10.2	.40
6.7	.26
MM	INCH

CONVERSION

METRIC

1. PROCESS AS FOLLOWS:
 (a) BEND NIPPLE TO DIMENSIONS SHOWN.
 (b) ZINC PLATE PER ES 2751DB.
 (c) CRIMP NUT PER ACES 2409P1.

(H 1)

ITEM NO.	MATERIAL	1SA8FRB6	1F40023-0806AB	FC1473-08S		
		AEROQUIP PART NUMBER	① NIPPLE	② NUT		
LIST OF MATERIALS						
1	STEEL	DRAWN: R.D. GARRETT CHECKED: M. MOLINA APPROVED: R.D. GARRETT RELEASE DATE: 1995-11-07 EN-F16053 DP-24900 THIRD ANGLE PROJECTION				
2	STEEL					
DRAWING TITLE					FLUID CONVEYANCE DIVISION NIPPLE ASSEMBLY 90°, ORS FEMALE SWIVEL, 2781 HOSE	
SIZE					DRAWING NUMBER	
SCALE		REV				
2/1		H				
DIST U		CAGE CODE				
01276		SHEET				
THE REPRODUCTION, DISTRIBUTION AND UTILIZATION OF THIS DOCUMENT AS WELL AS THE COMMUNICATION OF ITS CONTENTS TO OTHERS WITHOUT EXPLICIT AUTHORIZATION IS PROHIBITED. OFFENDERS WILL BE HELD LIABLE FOR THE PAYMENT OF DAMAGES. ALL RIGHT RESERVED IN THE EVENT OF THE GRANT OF A PATENT, UTILITY MODEL OR DESIGN. (PER ISO 18016)						