

REVISIONS			
REV	DESCRIPTION	DATE	APPROVED
E	REDRAWN - SUPERSEDES 1SA-FJA-REV. "D" FOR 1SA5FJA4. (1) WAS 10.1 REF.	10-9-95	EN-F16023 DP-24900

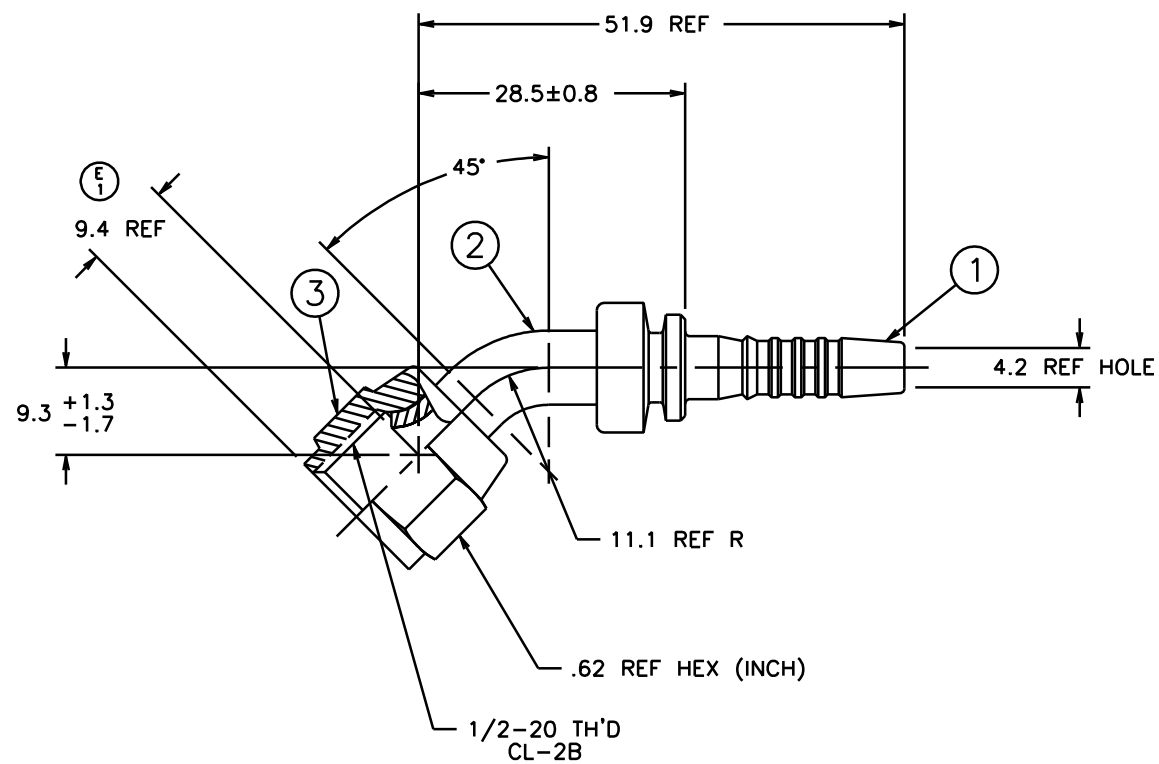

51.9	2.04
28.5±0.8	1.122±.031
11.1	.44
9.4	.37
9.3 +1.3 -1.7	.37 +.05 -0.07
4.2	.17
MM	INCH

CONVERSION

METRIC

DWG. NO. 1SA5FJA4 REV. E SH. 95

ITEM NO.	MATERIAL	1SA5FJA4 AEROQUIP PART NUMBER	1F40014-0504AB	1F40017-05-01AB	210221-5S
1	STEEL	① NIPPLE			
2	STEEL	② ELBOW			
3	STEEL	③ NUT			

LIST OF MATERIALS			
DRAWN	K.PADGETT	Aeroquip A TRINOVIA Company	
CHECKED	R.GARRETT	AEROQUIP CORPORATION Industrial Products Group Mounsee, Ohio, U.S.A.	
APPROVED	R.GARRETT	DRAWING TITLE	
RELEASE DATE	10-12-95	45°, SAE 37" SWIVEL, 2781 HOSE	
EN-F16023 DP-24900	SIZE C	DRAWING NUMBER	REV E
THIRD ANGLE PROJECTION	SCALE 2/1	DIST U	CAGE CODE 01276 SHEET NO

- △ CAN BE MADE FROM TUBING PER SPECIFICATIONS ON ELBOW DRAWING.
1. PROCESS AS FOLLOWS:
 (a) BRAZE PER ACES 2814.
 (b) ZINC PLATE PER ACES 2751.
 (c) ASSEMBLE NUT AND FLARE ELBOW PER FF481.

CONVERTED DRAWING CADAM to AutoCAD B/98