

REVISIONS			
REV	DESCRIPTION	DATE	APPROVED
H	REDRAWN - SUPERSEDES 1SA_FJB_SHEET 1/2 REV."G" FOR 1SA10FJB10 (1) WAS 13.7 REF. (2) WAS 30.3+2.4-0.5	11-9-95	EN-F16025 DP-24900
J	(1) NOTE #1 (b) WAS - "ZINC PLATE PER ACES 2751".	2020-05-28 AKG	CO-0203630

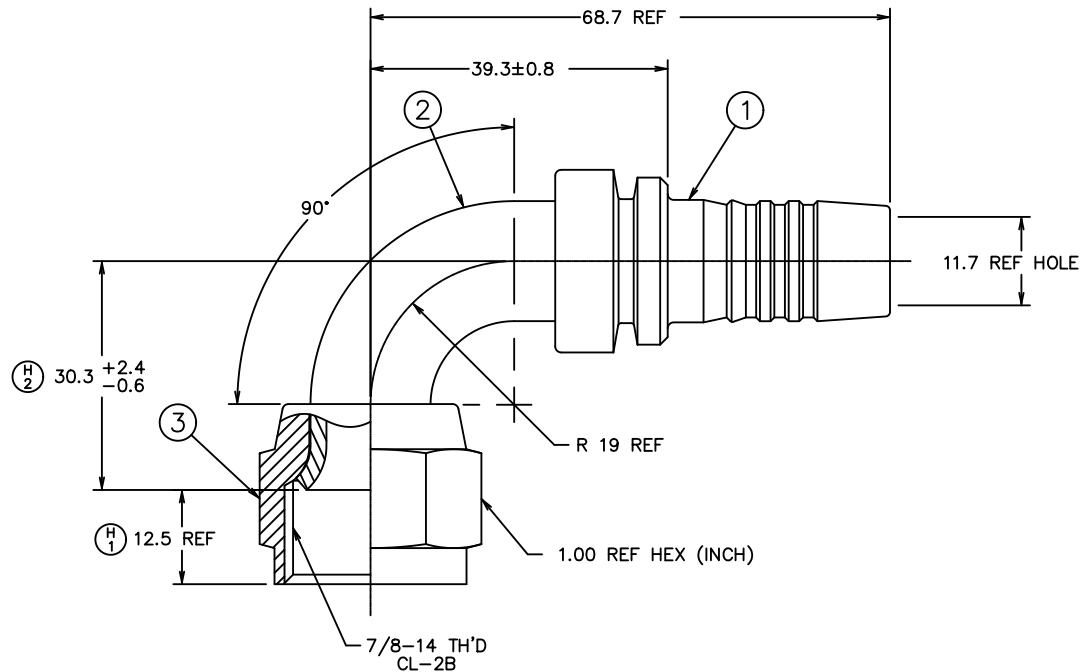

68.7	2.70
39.3±0.8	1.547±.031
30.3 +2.4 -0.6	1.19 +.10 -.02
19	.75
12.5	.49
11.7	.46
MM	INCH

CONVERSION

METRIC

△ CAN BE MADE FROM TUBING PER SPECIFICATIONS ON ELBOW DRAWING.

1. PROCESS AS FOLLOWS:

(a) BRAZE PER ACES 2814.

(b) ZINC PLATE PER ES 2751D8. ⊕

(c) ASSEMBLE NUT AND FLARE ELBOW PER FF481.

ITEM NO.	MATERIAL	DRAWN	CHECKED	APPROVED	RELEASE DATE	EN-F16025	DP-24900	THIRD ANGLE PROJECTION	SCALE	DIST	U	CAGE CODE	SHEET
1SA10FJB10	1F40014-1010AB	1F40016-10-01AB	210221-10S										
AEROQUIP PART NUMBER	① NIPPLE	② ELBOW	△ ③ NUT										
LIST OF MATERIALS													
1	STEEL	DRAWN R.D.GARRETT		FLUID CONVEYANCE DIVISION									
2	STEEL	CHECKED M. MOLINA		DRAWING TITLE									
3	STEEL	APPROVED R.D.GARRETT		NIPPLE ASSEMBLY									
		RELEASE DATE 1995-10-11		90°, SAE 37° SWIVEL									
		EN-F16025		2781 HOSE									
		DP-24900		SIZE	DRAWING NUMBER							REV	
		THIRD ANGLE PROJECTION		A2	1SA10FJB10							J	
		SCALE 2/1		DIST	U		CAGE CODE	01276		SHEET	1		
THE REPRODUCTION, DISTRIBUTION AND UTILIZATION OF THIS DOCUMENT AS WELL AS THE COMMUNICATION OF ITS CONTENTS TO OTHERS WITHOUT EXPLICIT AUTHORIZATION IS PROHIBITED. OFFENDERS WILL BE HELD LIABLE FOR THE PAYMENT OF DAMAGES. ALL RIGHT RESERVED IN THE EVENT OF THE GRANT OF A PATENT, UTILITY MODEL OR DESIGN. (PER ISO 16016)													