

DISPL CODE	G	MAX
022	132.2	[5.21]
025	133.1	[5.24]
030	134.6	[5.30]
036	136.4	[5.37]
040	137.6	[5.42]
049	140.3	[5.53]
062	144.2	[5.68]
080	149.6	[5.89]
096	154.5	[6.08]
119	161.2	[6.35]
149	170.3	[6.70]
187	181.7	[7.15]
226	193.3	[7.61]
298	215.0	[8.46]

REV	DESCRIPTION	BY	DATE	ECN
A	ENGINEERING RELEASE	RAF	2-8-94	M11208
B	-1<(3B) 88.9 [3.50] MAX WAS 84.6 [3.33] MAX -2<(2C) Ø 91.9 [3.62] MAX WAS Ø 88.8 [3.49] MAX	JMM	10-26-94	26147
C	<(4B) Ø13.59±0.38/-0.13 [5.35±0.015/-0.005] WAS Ø13.59±0.13 [5.35±0.005]	AGJ	1-28-02	39853
D	-1<(4B) WAS 96.8 [3.81] MAX. -2<(4D) WAS 131.4 [5.17] MAX.	AAK	04-07-04	46856
E	-1<(4D) UPDATED TABLE FOR DISPL CODE -2<(4A) NOTE 2 MOUNTING FLANGE WAS "A"	PM	03-27-07	0004355
F	<(4B) Ø 0.76 [0.030] M F E M WAS Ø 0.64 [0.025] M E M F	KNR	6-11-09	M76172
G	REVISED FOR STACK-UP	SMT	07-12-11	M82724
H	<(6A) NOTE 3 WAS CASE DRAIN : 0...	SSP	12-26-15	0069068_1

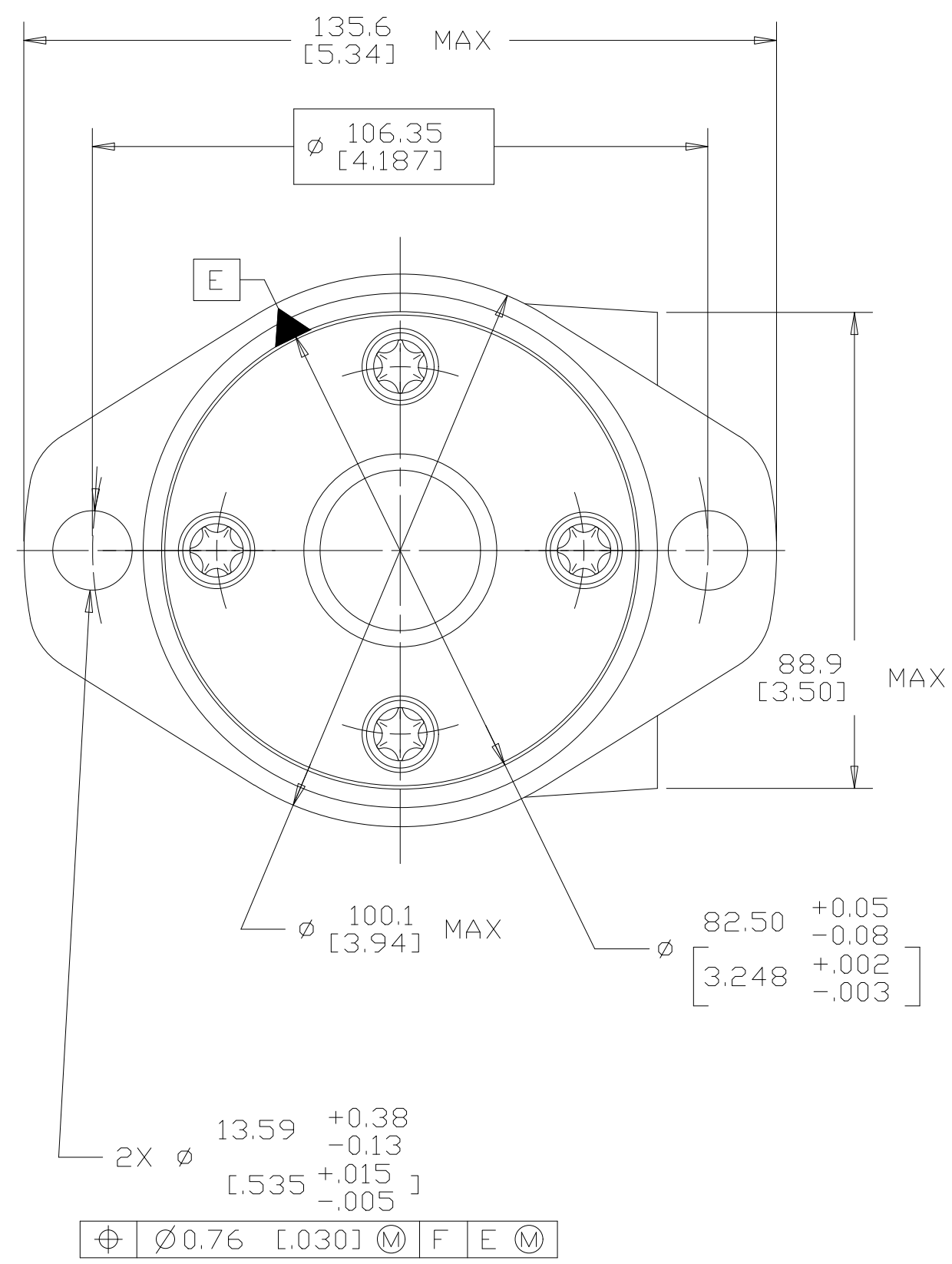

FOR SHAFT CONFIGURATION SEE SEPARATE SHAFT DRAWING

GROOVE PROVIDED FOR 82.6 [3.25] I.D. X 2.62 [0.103] CROSS SECTION O-RING (DASH NO 152)

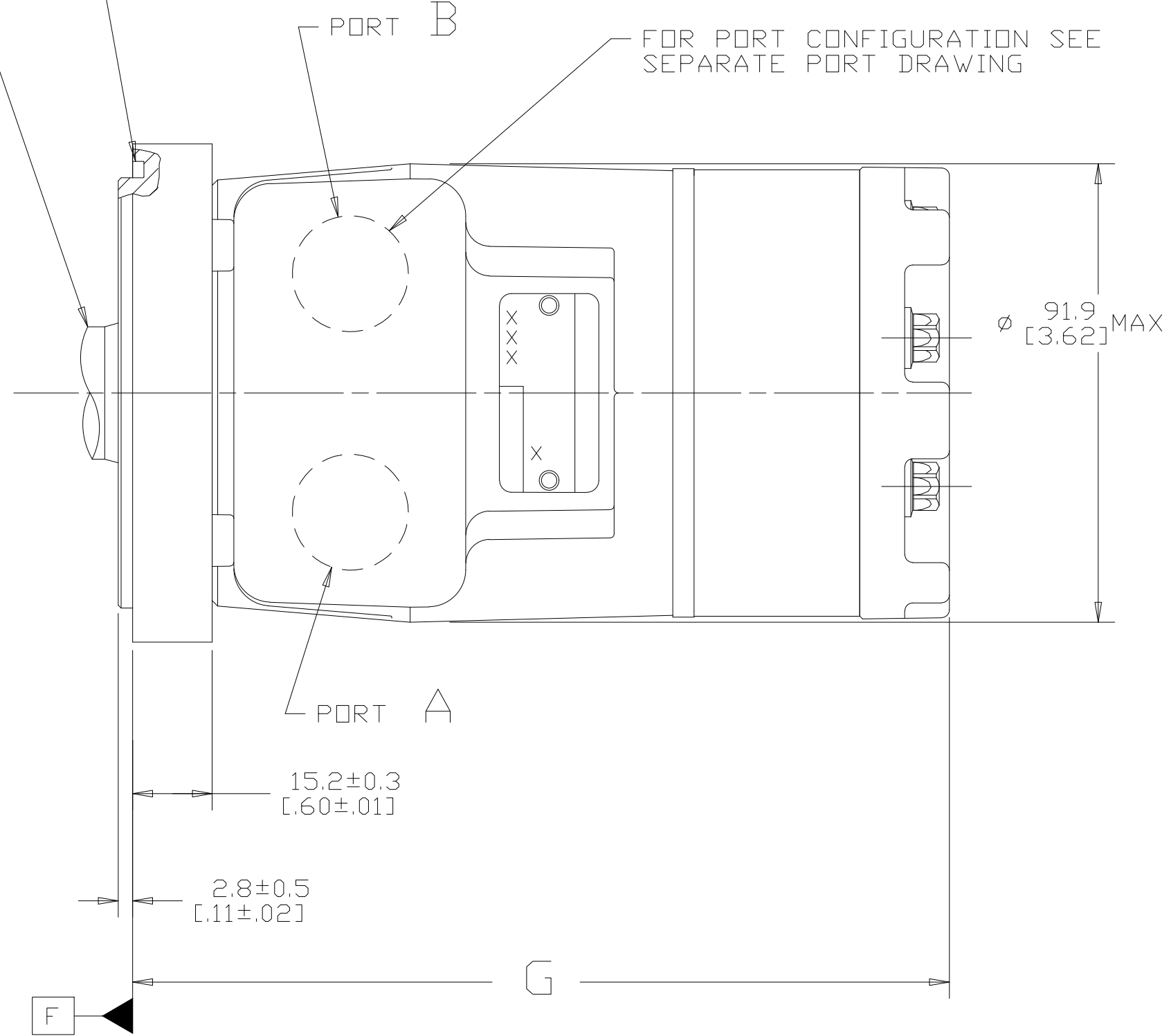

FOR PORT CONFIGURATION SEE SEPARATE PORT DRAWING

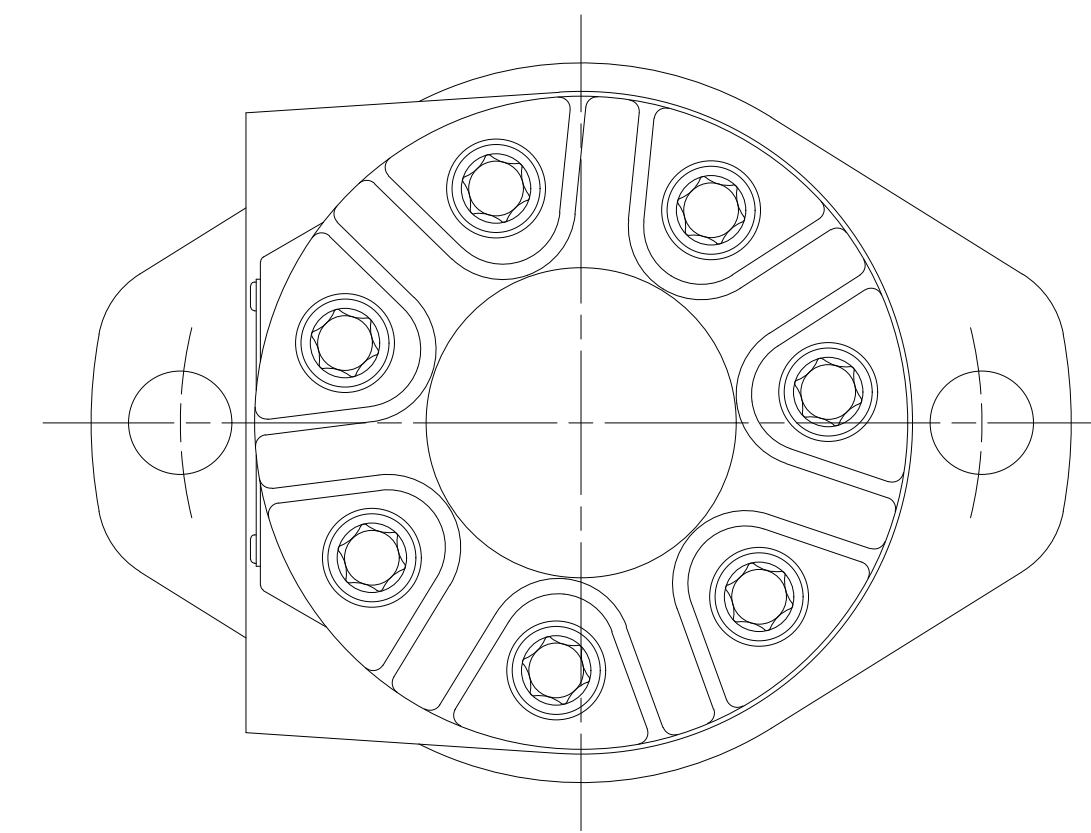

NOTE

- 1 ROTATION
STANDARD WHEN FACING SHAFT END OF MOTOR SHAFT TO ROTATE CLOCKWISE WHEN PORT "A" IS PRESSURIZED COUNTERCLOCKWISE WHEN PORT "B" IS PRESSURIZED

REVERSE WHEN FACING SHAFT END OF MOTOR SHAFT TO ROTATE COUNTERCLOCKWISE WHEN PORT "B" IS PRESSURIZED COUNTERCLOCKWISE WHEN PORT "A" IS PRESSURIZED
- 2 MOUNTING FLANGE
AA = STANDARD, 2 BOLT: Ø 82.6 [3.25] X 3.0 [0.12] PILDØ 13.59 [5.35] HOLES ON Ø 106.2 [4.18] BOLT CIRCLE
- 3 CASE DRAIN
00 = NO CASE DRAIN

REVIEWED FOR CLASSIFICATION PER ESP-042

UNLESS OTHERWISE SPECIFIED ALL DIMENSIONS ARE IN		DRAWING BASED ON ASME Y14.5M-1994			
INCHES	<input type="checkbox"/>	THE REPRODUCTION, DISTRIBUTION AND UTILIZATION OF THIS DOCUMENT AS WELL AS THE COMMUNICATION OF ITS CONTENTS TO OTHER WITHOUT EXPLICIT AUTHORIZATION IS PROHIBITED. OFFENDERS WILL BE HELD LIABLE FOR THE PAYMENT OF DAMAGES. ALL RIGHT RESERVED IN THE EVENT OF THE GRANT OF A PATENT, UTILITY MODEL OR DESIGN. (PER ISO 16016)			
MILLIMETERS	<input checked="" type="checkbox"/>				
TOLERANCES	X				
.XX ± ---	---	DRAWN BY/DATE	RAF 02-04-94	MATERIAL/HEAT TREAT	---
.XXX ± ---	---	CHECKED BY/DATE	SDR 02-23-94	TITLE	T MOTOR INSTALLATION DRAWING
< ± ---	---	ENGRG BY/DATE	RVA 03-03-94	NUMBER	A-821-008
UNSPECIFIED RADII ARE:	---	METALLURGY BY/DATE	---	SCALE	1/1 SHEET 1 OF 1
UNSPECIFIED DRAFT ANGLES ARE:	---	THIRD ANGLE PROJECTION	<input checked="" type="checkbox"/>	DO NOT SCALE	
D SIZE		ARITHMETICAL AVERAGE	<input type="checkbox"/>		