

DISPL CODE	G	MAX
018	132.2	[5.21]
022	132.2	[5.21]
025	133.1	[5.24]
030	134.6	[5.30]
036	136.4	[5.37]
040	137.6	[5.42]
049	140.3	[5.53]
062	144.2	[5.68]
080	149.6	[5.89]
096	154.5	[6.08]
119	161.2	[6.35]
149	170.3	[6.70]
187	181.7	[7.15]
226	193.3	[7.61]
298	215.0	[8.46]

REV	DESCRIPTION	BY	CHK	DATE	ECN / MPS
A	ENGINEERING RELEASE	RAF		2-8-94	M11208
F	REVISED	SSD		10-15-09	M77172
G	-1)<3B>15.2±0.3 WAS 17.3±0.3 [.60±.01] [.68±.01] -2)<4D>TABULATION BLOCK REVISED AS PER STACK-UP	HAT	SMT	01-07-13	0046103
H	<4D>G MAX VALUE OF DISP CODE 080 WAS 149.6 [6.89]	YUP		12-04-13	0053338
J	<4A> NOTE 3 WAS CASE DRAIN :0.....	SSP	SMT	12-26-15	0068068_1
K	<4A> ADDED NOTE 4	JVD	CSG	07-05-16	M101233

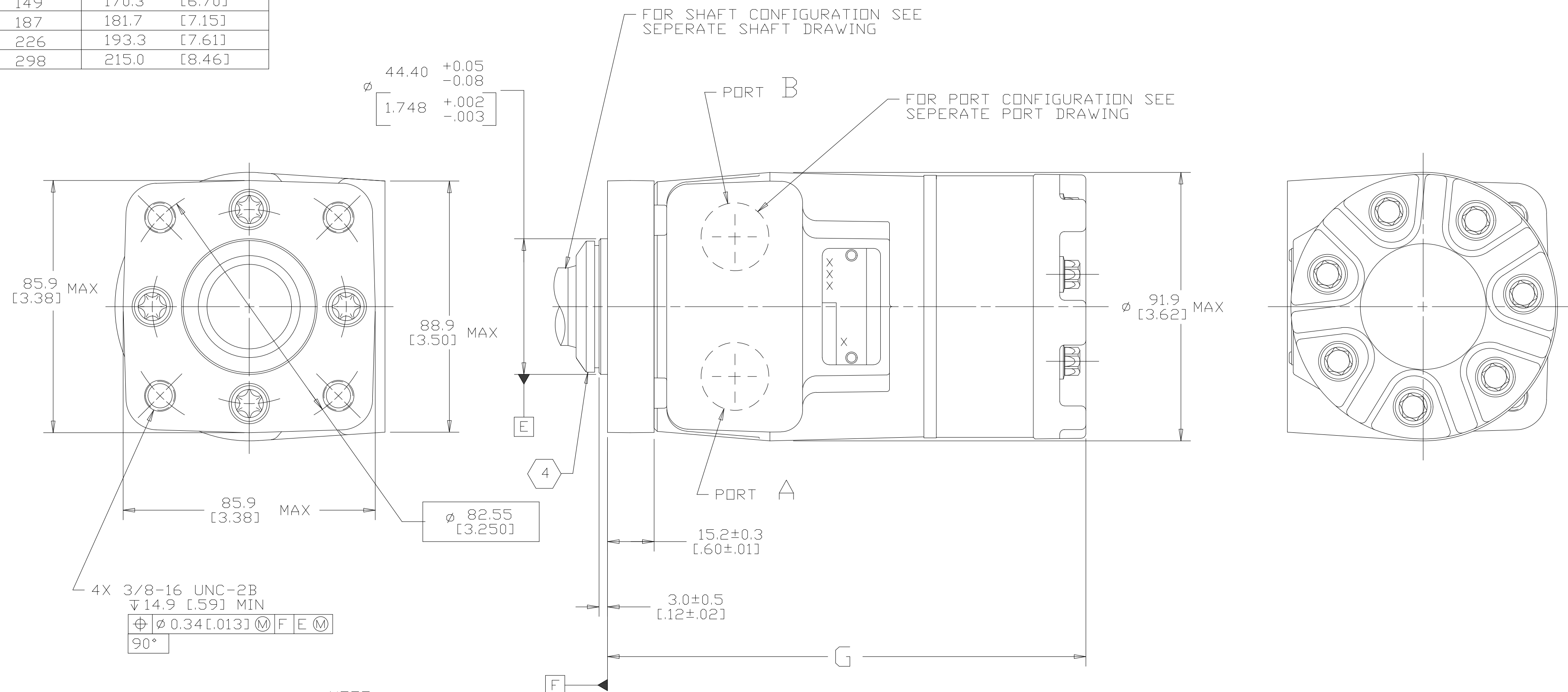

- NOTE
- 1 ROTATION STANDARD WHEN FACING SHAFT END OF MOTOR SHAFT TO ROTATE CLOCKWISE WHEN PORT "A" IS PRESSURIZED COUNTERCLOCKWISE WHEN PORT "B" IS PRESSURIZED
  - REVERSE WHEN FACING SHAFT END OF MOTOR, SHAFT TO ROTATE CLOCKWISE WHEN PORT "B" IS PRESSURIZED COUNTERCLOCKWISE WHEN PORT "A" IS PRESSURIZED
  - 2 MOUNTING FLANGE BA,BT = STANDARD, 4 BOLT: ⌀ 44.4 [1.75] X 3.0 [1.2] PILOT 3/8-16 THREADED HOLES ON ⌀ 82.6 [3.25] BOLT CIRCLE
  - 3 CASE DRAIN 00 = NO CASE DRAIN
  - 4 APPLICABLE FOR SEAL OPTIONS : 2,11,12,13 (SLINGER SEAL)

REVIEWED FOR CLASSIFICATION PER ESP-042

UNLESS OTHERWISE SPECIFIED ALL DIMENSIONS ARE IN INCHES MILLIMETERS (INCHES)	DRAWING BASED ON ASME Y14.5-2009	
	THE REPRODUCTION, DISTRIBUTION AND UTILIZATION OF THIS DOCUMENT AS WELL AS THE COMMUNICATION OF ITS CONTENTS TO OTHER WITHOUT EXPLICIT AUTHORIZATION IS PROHIBITED. OFFENDERS WILL BE HELD LIABLE FOR THE PAYMENT OF DAMAGES. ALL RIGHT RESERVED IN THE EVENT OF THE GRANT OF A PATENT, UTILITY MODEL OR DESIGN. (PER ISO 16016)	
TOLERANCES .X ± --- .XX ± --- .XXX ± --- α ± ---°	DRAWN RAF BY/DATE 2-4-94	MATERIAL/HEAT TREAT -
UNSPECIFIED RADII ARE: -----	CHECKED SDR BY/DATE 2-23-94	TITLE T MOTOR INSTALLATION
UNSPECIFIED DRAFT ANGLES ARE: -----°	ENGRG RVA BY/DATE 3-3-94	NUMBER A-821-002
C SIZE	THIRD ANGLE PROJECTION DO NOT SCALE	SCALE 1/1 SHEET 1 OF 1