

DISPL CODE	G MAX
022	132.2 [5.21]
025	133.1 [5.24]
030	134.6 [5.30]
036	136.4 [5.37]
040	137.6 [5.42]
049	140.3 [5.52]
062	144.2 [5.68]
080	149.6 [5.89]
096	154.5 [6.08]
119	161.2 [6.35]
149	170.3 [6.70]
187	181.6 [7.15]
226	193.3 [7.61]
298	215.0 [8.46]

REV	DESCRIPTION	BY	DATE	ECN
A	ENGINEERING RELEASE	RAF	2-8-94	M11208
E	REVISED	SSD	09-18-09	M76973
F	(4A) NOTE 3 WAS CASE DRAIN : 0.....	SSP	12-26-15	0068068_1

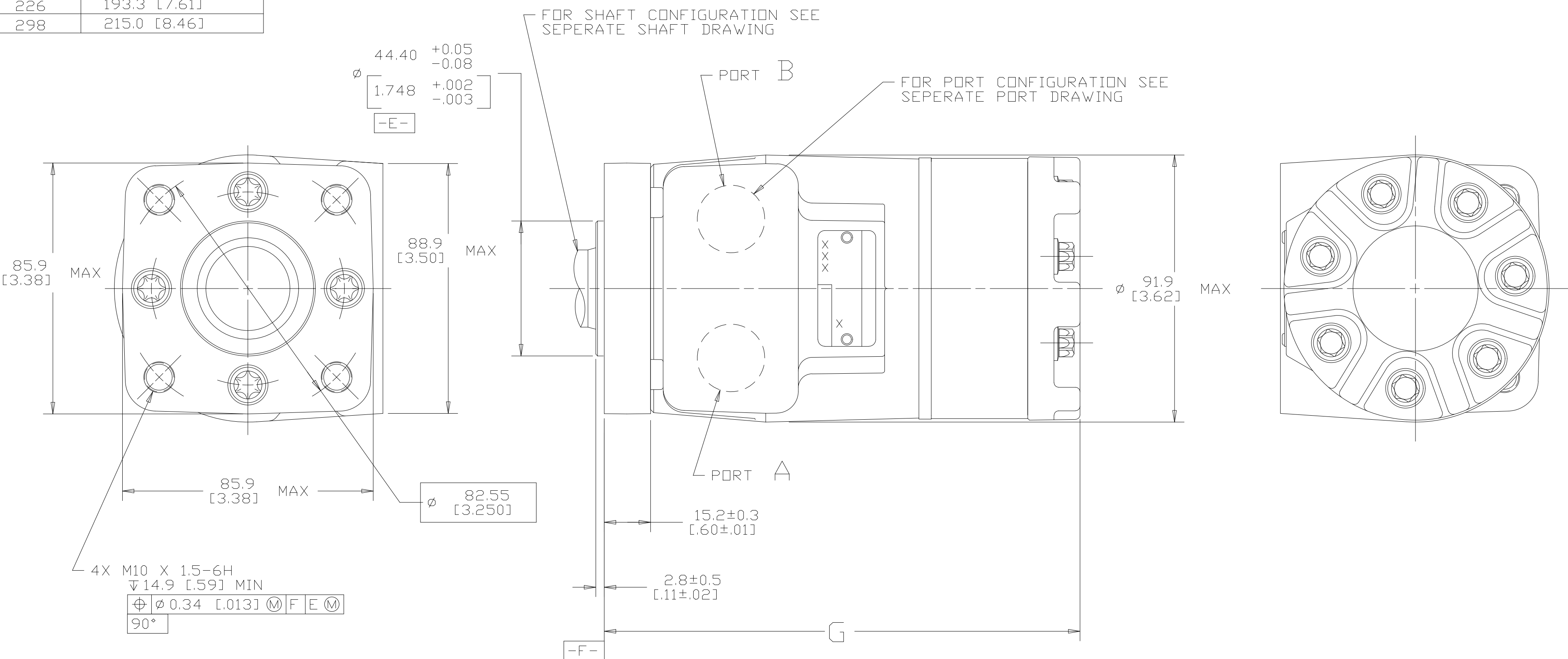

NOTE

1 ROTATION STANDARD WHEN FACING SHAFT END OF MOTOR SHAFT TO ROTATE CLOCKWISE WHEN PORT "A" IS PRESSURIZED COUNTERCLOCKWISE WHEN PORT "B" IS PRESSURIZED

REVERSE WHEN FACING SHAFT END OF MOTOR, SHAFT TO ROTATE CLOCKWISE WHEN PORT "B" IS PRESSURIZED COUNTERCLOCKWISE WHEN PORT "A" IS PRESSURIZED

2 MOUNTING FLANGE FA = STANDARD, 4 BOLT:  $\phi$  44.4 [1.75] X 3.0 [.12] PILOT M10 X 1.5-6H MOUNTING HOLES ON  $\phi$  82.6 [3.25] BOLT CIRCLE

3 CASE DRAIN 00 = NO CASE DRAIN

**CS** REVIEWED FOR CLASSIFICATION PER ESP-042

UNLESS OTHERWISE SPECIFIED ALL DIMENSIONS ARE IN INCHES  MILLIMETERS [INCHES]

TOLERANCES

.X	$\pm$ ---
.XX	$\pm$ ---
.XXX	$\pm$ ---
$\phi$	$\pm$ ---°

UNSPECIFIED RADII ARE: -----

UNSPECIFIED DRAFT ANGLES ARE: -----°

C SIZE

DRAWING BASED ON ANSI Y14.5M-1982

THE REPRODUCTION, DISTRIBUTION AND UTILIZATION OF THIS DOCUMENT AS WELL AS THE COMMUNICATION OF ITS CONTENTS TO OTHER WITHOUT EXPLICIT AUTHORIZATION IS PROHIBITED. OFFENDERS WILL BE HELD LIABLE FOR THE PAYMENT OF DAMAGES. ALL RIGHT RESERVED IN THE EVENT OF THE GRANT OF A PATENT, UTILITY MODEL OR DESIGN. (PER ISO 16016)

**Danfoss**

DRAWN BY/DATE: RAF 2-4-94	MATERIAL/HEAT TREAT: -
CHECKED BY/DATE: SDR 2-23-94	TITLE: T-MOTOR INSTALLATION
ENGRG BY/DATE: RVA 3-3-94	NUMBER: A-821-005
METALLURGY BY/DATE: -----	SCALE: 1/1 SHEET 1 OF 1

THIRD ANGLE PROJECTION

DO NOT SCALE

ARITHMETICAL AVERAGE