

DISPL CODE	D	C MAX
05	87.10±0.81 [3.429±.032]	104.17 [4.101]
08	91.17±0.81 [3.550±.032]	107.24 [4.222]
10	92.41±0.81 [3.638±.032]	109.47 [4.310]
12	94.62±0.81 [3.725±.032]	111.68 [4.397]
19	102.26±0.81 [4.026±.032]	119.33 [4.698]
30	113.61±0.81 [4.473±.032]	130.68 [5.145]

REV	DESCRIPTION	BY	CHK	DATE	ECN
A	ENGINEERING RELEASE	RAF		1-23-96	27675
B	(4D)ADDED DISPLACEMENT CODE 30	RAF		2-26-96	M15000
C	-1(X4D)REVISED TABULATED VALUES FOR D AND C -2)DRAWING UPDATED TO ASME Y14.5-2009 STANDARD	JVDCSG		02-05-15	M95526
D	-1(X3C)(3B)(3A)(2C) REVISED PICTORIALLY -2)DIMENSIONS REVISED FOR STACK-UP -3)(4D)ADDED DISPLACEMENT CODE 10	YUP	YUP	09-27-15	0062470

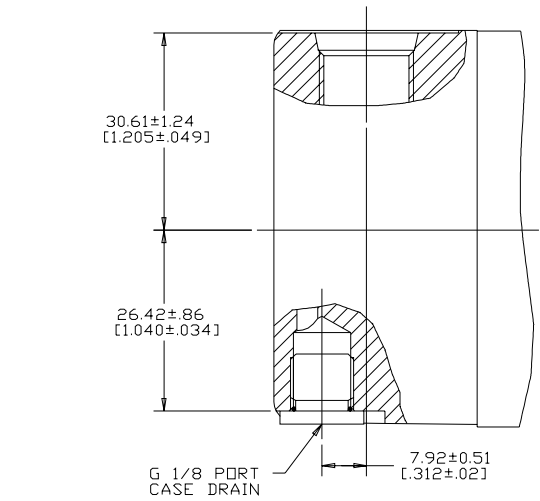
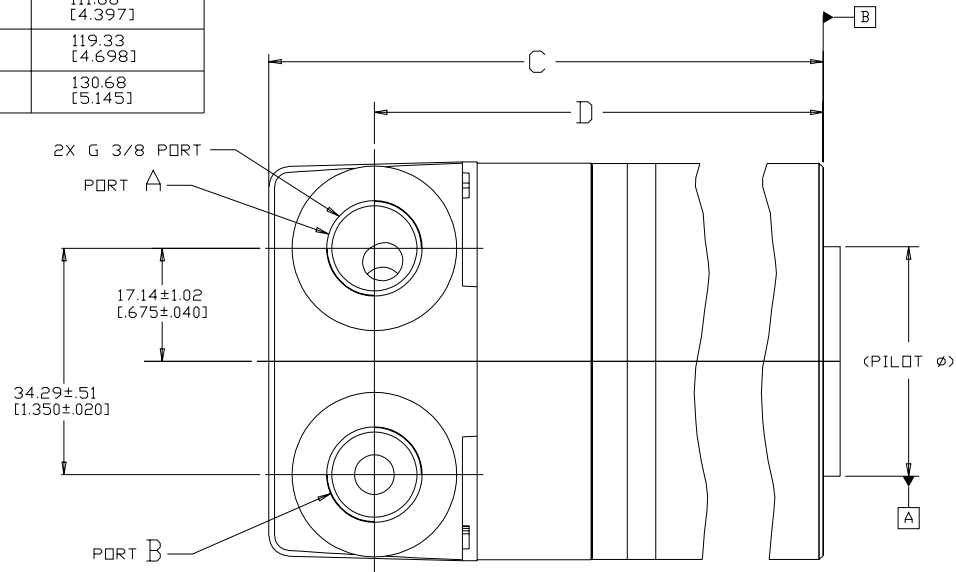

NOTE  
1 PORT TYPE E

UNLESS OTHERWISE SPECIFIED ALL DIMENSIONS ARE IN INCHES <input type="checkbox"/> MILLIMETERS (INCHES) <input checked="" type="checkbox"/>		DRAWING BASED ON ASME Y14.5-2009	
TOLERANCES X ± ---- XX ± REF XXX ± ONLY ∠ ± ----		EATON CORPORATION - CONFIDENTIAL AND PROPRIETARY NOTICE TO PERSONS RECEIVING THIS DRAWING AND / OR TECHNICAL INFORMATION <b>EATON</b> Powering Business Worldwide Eaton Hydraulics LLC 14615 Lone Dale Road Eden Prairie, MN 55344 USA	
DRAWN BY/DATE RAF 2-9-96 CHECKED BY/DATE SDR 2-22-96		MATERIAL/HEAT TREAT	
UNSPECIFIED RADI ARE ----		METALLURGY BY/DATE	
UNSPECIFIED DRAFT ANGLES ARE ----		THIRD ANGLE PROJECTION	
D SIZE		DO NOT SCALE	
MICROINCHES <input type="checkbox"/> MILLIMETERS (MICROINCHES) <input checked="" type="checkbox"/>		NUMBER A-818-029	
ARITHMETICAL AVERAGE <input checked="" type="checkbox"/>		SCALE 2/1 SHEET 1 OF 1	