

REV	DESCRIPTION	BY	DATE	ECN
A	ENGINEERING RELEASE	AGJ	5-26-93	22833
B	7.9/4.1 [.31/.16] WAS 9.2/4.5 [.36/.18]	RAF	2-8-96	MI 4882
C	NOTE 1 WAS MOUNTING TYPE: OPTION C	AGJ	5-13-02	41044
D	65.5/63.5 [2.58/2.50] WAS 65.8/63.5 [2.59/2.50]	AGJ	5-17-04	47918
E	NOTE 2 WAS OUTPUT SHAFT: OPTION 23 & 30	PM	4-4-06	54522

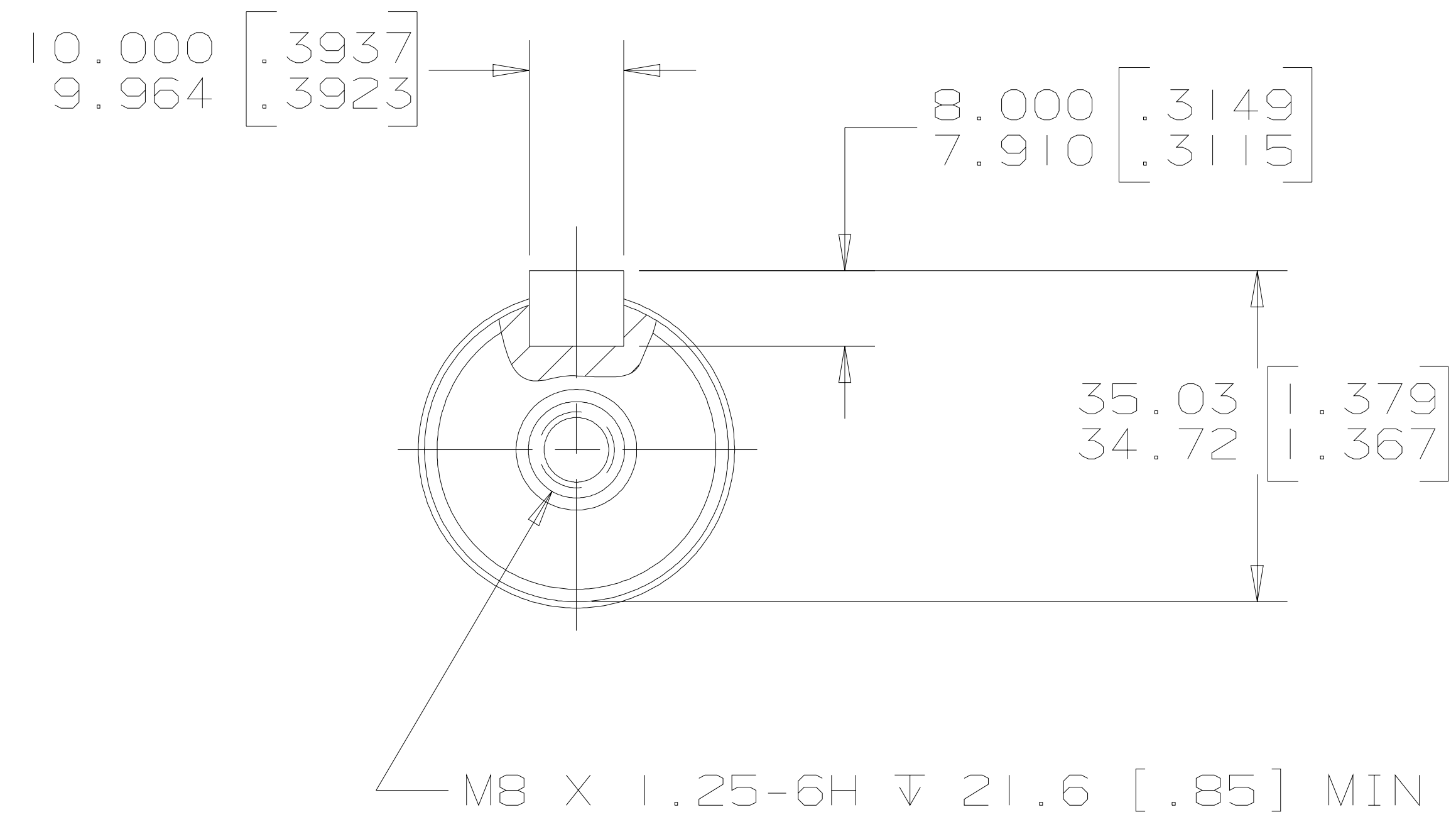
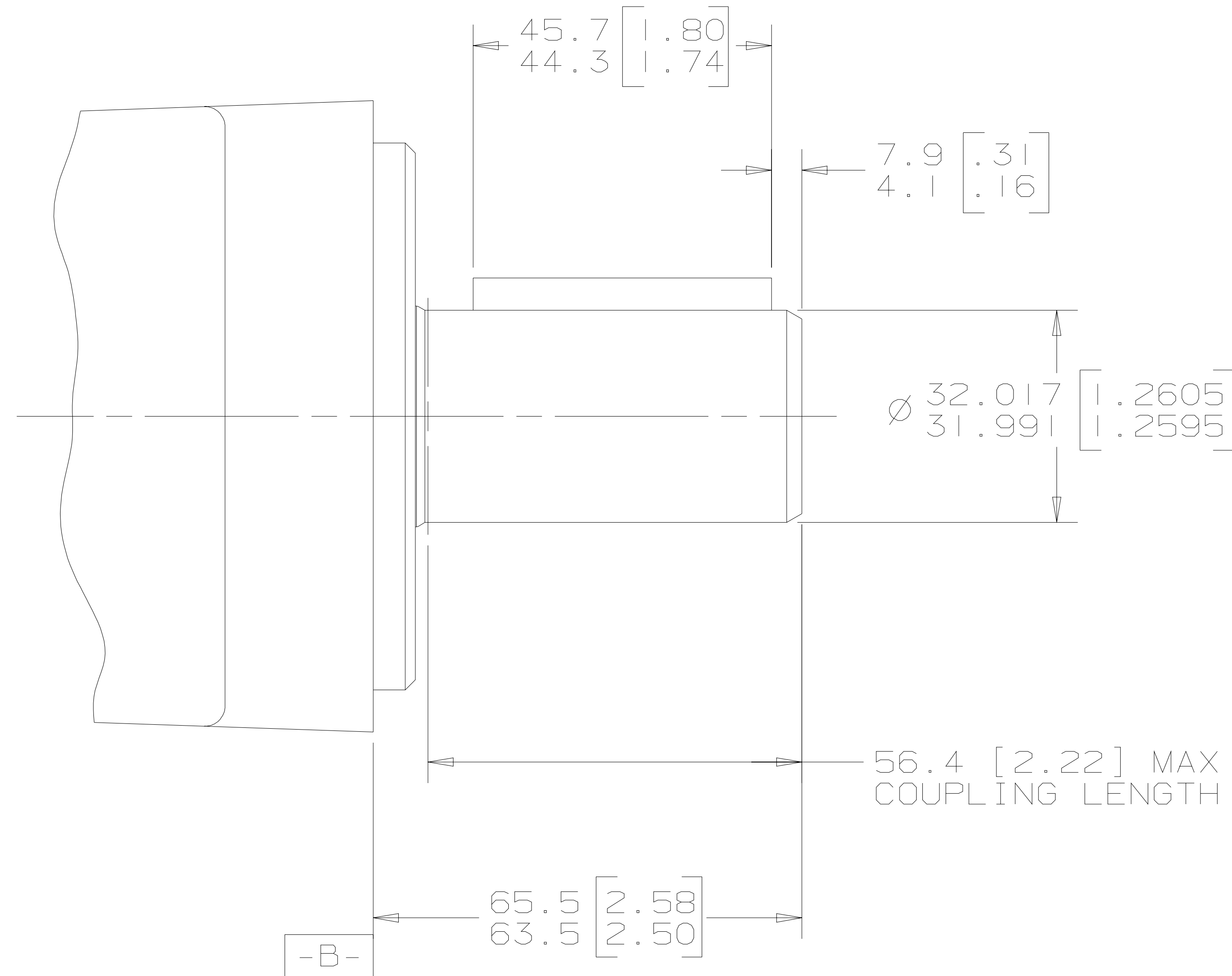

G K S

NOTE

- 1 MOUNTING TYPE: OPTION AC, BA & BE
- 2 OUTPUT SHAFT: OPTION 16 & 22

UNLESS OTHERWISE SPECIFIED ALL DIMENSIONS ARE IN INCHES <input type="checkbox"/> MILLIMETERS [INCHES] <input checked="" type="checkbox"/>	DRAWING BASED ON ANSI Y14.5M-1982	
	NOTICE TO PERSONS RECEIVING THIS DRAWING AND / OR TECHNICAL INFORMATION Eaton Corporation claims proprietary rights in the information disclosed hereon. This document is issued in confidence and is not to be reproduced or used to manufacture anything shown hereon without the written permission of the Eaton Corporation.	
<b>TOLERANCES</b> .X ± ---- .XX ± REF .XXX ± ONLY < ± ----	DRAWN BY/DATE: A. JOHNSON / 3-15-93 CHECKED BY/DATE: SDR / 6-24-93 ENGRG BY/DATE: SJZ / 6-28-93 METALLURGY BY/DATE: ----	MATERIAL/HEAT TREAT  TITLE: 2000 SERIES MOTOR SHAFT INSTALLATION
UNSPECIFIED RADII ARE ----  UNSPECIFIED DRAFT ANGLES ARE ----	THIRD ANGLE PROJECTION 	MICROINCHES <input type="checkbox"/> MICROMETERS [MICROINCHES] <input type="checkbox"/> ARITHMETICAL AVERAGE <input checked="" type="checkbox"/>
DRAWING FORMAT CADD <input checked="" type="checkbox"/> MANUAL <input type="checkbox"/>	DO NOT SCALE	NUMBER: A-683-023 SCALE: 1/1 SHEET: 1 OF 1

