

SYM	REVISION	BY	DATE	ECN
A	ENGINEERING RELEASE	RLL	11-10-87	14736
B	.42/10,7 MIN. DP. WAS .56/14,2 MIN. DP.	RAF	6-14-94	25639

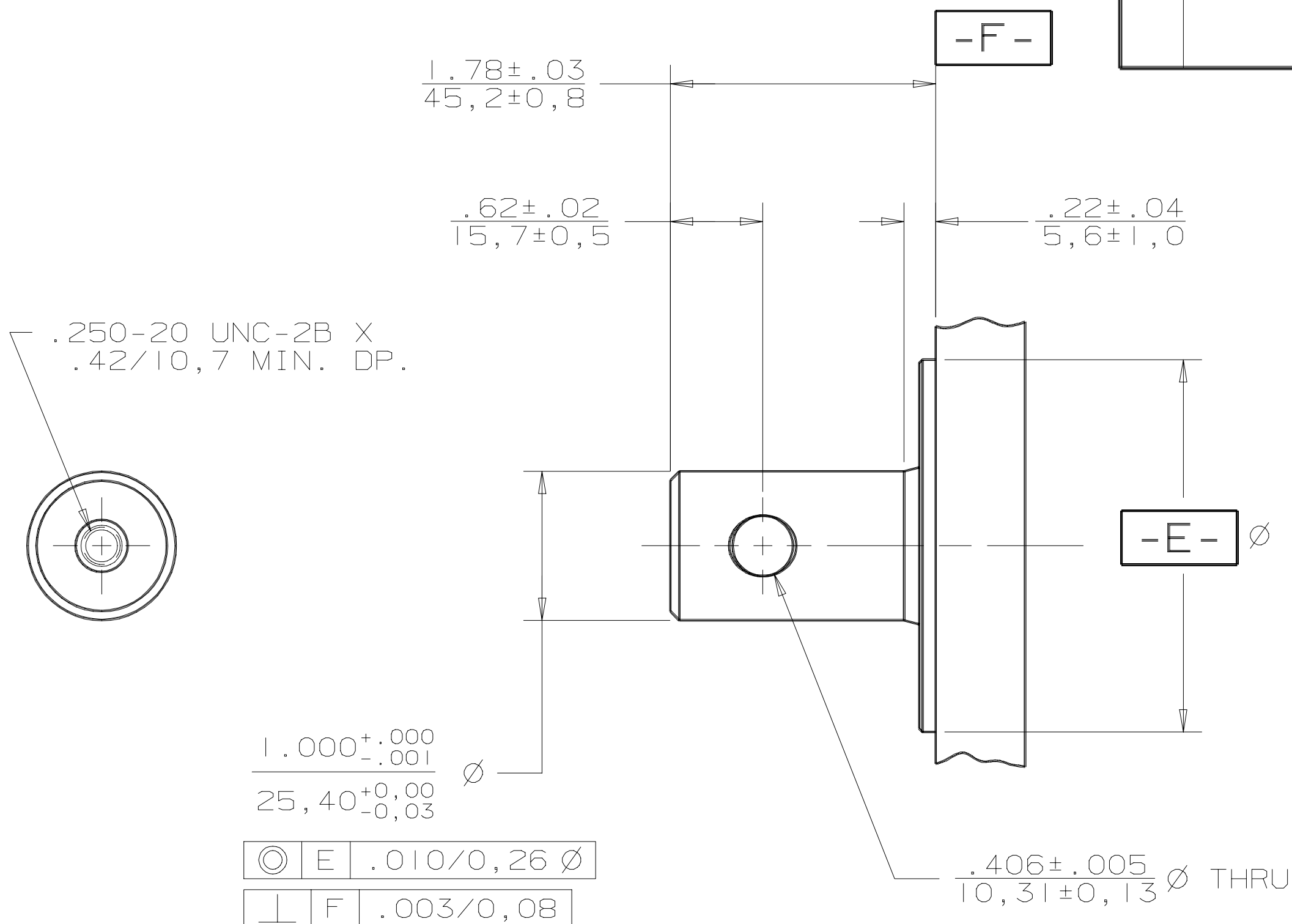

.250-20 UNC-2B X  
.42/10,7 MIN. DP.

$\frac{1.000^{+.000}}{25,40^{+0,00}} \varnothing$   
 $\frac{-0,001}{-0,03}$

⊙ E .010/0,26 ⌀  
⊥ F .003/0,08

$\frac{.406 \pm .005}{10,31 \pm 0,13} \varnothing$  THRU

MODEL NO.  
MOXXXX08XXXXXXXX

SMG<sup>2</sup>

NOTICE TO PERSONS RECEIVING THIS DRAWING AND / OR TECHNICAL INFORMATION Eaton Corporation claims proprietary rights in the information disclosed hereon. This document is issued in confidence and is not to be reproduced or used to manufacture anything shown hereon without the written permission of the Eaton Corporation.		 Eaton Corporation Hydraulics Division 15151 Highway 5 Eden Prairie, Mn. 55344	
DRAWN BY/DATE RLL 10-29-87	MATERIAL/HEAT TREAT		
CHECKED BY/DATE KQ 1-13-88	TITLE SHAFT INSTALLATION		
ENGRG BY/DATE WCW 1-19-88	DO NOT SCALE		
 THIRD ANGLE PROJECTION	LINEAR MEASUREMENT IN/MM IN MM	NUMBER A-109-008	
SCALE FULL SIZE		SHEET 1 OF 1	

OUTPUT SHAFT  
08 = 1.00/25,4 DIA. STRAIGHT WITH .40/10,2 DIA. CROSSHOLE .62/15,7 FROM END, AND .250-20 THREADED HOLE